

CAPS

HEAVY DUTY CAPS

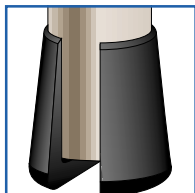

PART NUMBER	TUBE O.D. SIZE	STYLE	COLOR
210-3800	3/8"	B	BLACK
210-0096	9/16"	A	BLACK
210-0625	5/8"	B	BLACK
100-0132	3/4" WITH HOLE	A	BLACK
210-0304	2-1/2"	C	BLACK
210-0750	3/4"	A	BLACK
210-0875	7/8"	B	BLACK
210-1000	1"	A	BLACK
210-1000-HL	1"	B	BLACK
100-0118	1" BALL WITH 1/2" SQUARE HOLE		BLACK
210-1100-HD	1.100"	C	BLACK
210-1125-HD	1-1/8"	C	BLACK
210-1250	1-1/4"	A	BLACK
210-1500	1-1/2"	A	BLACK

SPECIFICATIONS

- *Standard Color:* Black
- *Standard Material:* Low Density Polyethylene
- *Optional Materials:* Nylon, Thermoplastic Rubber (TPR)

100/210 Series

Heavy Duty Caps, designed for institutional applications, incorporate a thick internal ledge to resist cutthrough by sharp tubing ends.

HIGH SILHOUETTE CAPS

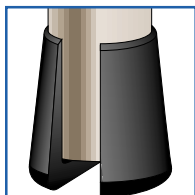

PART NUMBER	TO FIT TUBE	MATERIAL	COLOR
149PB-0500-0000	0.500"	POLYETHYLENE	BLACK
149PB-0625-0000	0.625"	POLYETHYLENE	BLACK
149PB-0750-0000	0.750"	POLYETHYLENE	BLACK

SPECIFICATIONS

- *Standard Color:* Black
- *Standard Material:* Polyethylene

149 Series

High Silhouette Caps are a taller companion line to Low Silhouette Caps. They are designed as a low-cost alternative for heavy duty application.

LOW SILHOUETTE CAPS

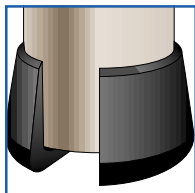

PART NUMBER	TO FIT TUBE	MATERIAL	COLOR
147LN-0500-0000	0.500"	POLYETHYLENE	WHITE
147PB-0625-0000	0.625"	POLYETHYLENE	BLACK
147PB-0750-0000	0.750"	POLYETHYLENE	BLACK
147PB-1000-0000	1.000"	POLYETHYLENE	BLACK
147PB-1500-0000	1.500"	POLYETHYLENE	BLACK

SPECIFICATIONS

- *Standard Color:* See Chart
- *Standard Material:* Polyethylene

147 Series

Low Silhouette Caps have a thick base and wall construction for maximum durability.





PART NUMBER	TO FIT TUBE	MATERIAL	COLOR
171EW-0625-0000	0.625"	ELASTOMERIC POLY	WHITE
171EB-0750-0000	0.750"	ELASTOMERIC POLY	BLACK
171EB-0875-0000	0.875"	ELASTOMERIC POLY	BLACK
171EW-0875-0000	0.875"	ELASTOMERIC POLY	WHITE
171EB-1000-0200	1.000"	ELASTOMERIC POLY	BLACK
171EW-1000-0200	1.000"	ELASTOMERIC POLY	WHITE

SPECIFICATIONS

- Standard Color: See Chart
- Standard Material: Elastomeric Polyethylene

171 Series

HighLine Domed Caps are tall and durable. Ideal for nonskid applications, these caps have a thinner wall section than High Silhouette Caps resulting in ease of installation.

HIGH - LINE DOMED CAPS

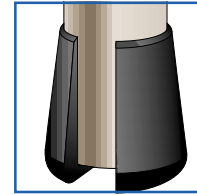

PART NUMBER	TO FIT TUBE	MATERIAL	COLOR
172EB-0875-0300	0.875"	ELASTOMERIC POLY	BLACK
172EW-1000-0300	1.000"	ELASTOMERIC POLY	WHITE
172EB-1000-0300	1.000"	ELASTOMERIC POLY	BLACK

SPECIFICATIONS

- Standard Color: See Chart
- Standard Material: Elastomeric Polyethylene

172 Series

LowLine Dome Caps have a thick rounded base for long wear and use on a wide range of leg angles. LowLine Dome Caps are manufactured in Elastomeric Polyethylene to suit a wide variety of non-skid applications.

LOW - LINE DOMED CAPS



For more options, ask about our 210 Series of Round Caps!



PART NUMBER	TO FIT TUBE	MATERIAL	COLOR
144PB-0375-0000	0.375"	POLYETHYLENE	BLACK
144PB-0500-0000	0.500"	POLYETHYLENE	BLACK
144PW-0500-0000	0.500"	POLYETHYLENE	WHITE
144PB-0625-0000	0.625"	POLYETHYLENE	BLACK
144PW-0625-0000	0.625"	POLYETHYLENE	WHITE
144PB-0750-0000	0.750"	POLYETHYLENE	BLACK
144PW-0750-0000	0.750"	POLYETHYLENE	WHITE
144PG-0750-0000	0.750"	POLYETHYLENE	GRAY
144PB-0875-0000	0.875"	POLYETHYLENE	BLACK
144PW-0875-0000	0.875"	POLYETHYLENE	WHITE
144PW-1000-0000	1.000"	POLYETHYLENE	WHITE
144PB-1000-0000	1.000"	POLYETHYLENE	BLACK
144PW-1125-0000	1.125"	POLYETHYLENE	WHITE
144PB-1125-0000	1.125"	POLYETHYLENE	BLACK
144PW-1250-0000	1.250"	POLYETHYLENE	WHITE
144PB-1250-0000	1.250"	POLYETHYLENE	BLACK

SPECIFICATIONS

- Standard Color: See Chart
- Standard Material: Polyethylene

144 Series

Alliance Plastics' Slenda Cap is an industry standard for light duty applications due to its low cost. An integrated step lead permits fast positioning and quick assembly from this economically and attractive means of finishing the end of rod or tubing.

ROUND SLENDA™ CAPS



CAPS

ROUND CAPS WITH OVERSIZED BASE



PART NUMBER	TO FIT TUBE	BASE DIAMETER	MATERIAL	COLOR
154PB-7504-0000	0.180"	0.625"	POLYETHYLENE	BLACK
154PB-7503-0000	0.250"	0.750"	POLYETHYLENE	BLACK
154PB-7614-0000	0.250"	1.000"	POLYETHYLENE	BLACK
154PB-7735-0000	0.312"	1.000"	POLYETHYLENE	BLACK
154PB-7730-0000	0.375"	1.000"	POLYETHYLENE	BLACK

SPECIFICATIONS

- *Standard Color: Black*
- *Standard Material: Polyethylene*

154 Series

BALL CAPS



PART NUMBER	TUBE O.D.	BALL O.D.	MATERIAL	COLOR
253BB-7707-0000	0.312"	0.625"	BUTYRATE	BLACK
253BB-7767-0000	0.375"	0.625"	BUTYRATE	BLACK
253PB-7602-0000	0.375"	1.000"	POLYETHYLENE	BLACK
253LN-7775-0000	0.500"	0.875"	LINEAR POLYETHYLENE	WHITE
253BB-7775-0000	0.500"	0.875"	BUTYRATE	BLACK
253PB-7775-0000	0.500"	0.875"	POLYETHYLENE	BLACK
253PB-7785-0000	0.625"	1.000"	POLYETHYLENE	BLACK
253LG-7719-0000	0.875"	1.312"	LINEAR POLYETHYLENE	GRAY

SPECIFICATIONS

- *Standard Color: Black*
- *Standard Material: Polyethylene*

253 Series

Ball Caps are a popular style of heavy duty glide in which the ball will greatly enhance the leg design of a given application, as well as accommodate a wide variety of leg angles. Ball Caps may also be used as a decorative top or finial and maintain an excellent press fit.

SQUARE CAPS



PART NUMBER	TUBE O.D. SIZE	STYLE	MATERIAL	COLOR
211-0500	1/2"	END CAP	LOW DENSITY POLYETHYLENE	BLACK
211-1000	1"	END CAP	LOW DENSITY POLYETHYLENE	BLACK
211-1250	1-1/4"	END CAP	LOW DENSITY POLYETHYLENE	BLACK
211-3000	3"	END CAP	LOW DENSITY POLYETHYLENE	BLACK

SPECIFICATIONS

- *Standard Color: Black*
- *Standard Material: Low Density Polyethylene*
- *Optional Materials: Nylon, Thermoplastic Rubber (TPR)*

211 Series

Designed to fit most popular sizes of square tubular steel.



PART NUMBER	TO FIT TUBE	DEPTH	MATERIAL	COLOR
145PB-6535-0000	0.500" X 1.000"	1/2"	POLYETHYLENE	BLACK
145PB-6527-0000	1.000" X 2.000"	1/2"	POLYETHYLENE	BLACK

SPECIFICATIONS

- *Standard Color: Black*
- *Standard Material: Polyethylene*

145 Series

RECTANGULAR CAPS FOR TUBING



PART NUMBER	BAR DIMENSION	BASE DEPTH	STYLE	MATERIAL	COLOR
161PB-0240-0000	0.125" X 0.750"	0.406"	FLAT	POLYETHYLENE	BLACK
161PB-0242-0000	0.187" X 1.000"	1.032"	ROUND	POLYETHYLENE	BLACK
161PB-0253-0000	0.250" X 1.000"	0.625"	FLAT	POLYETHYLENE	BLACK

SPECIFICATIONS

- *Standard Color: Black*
- *Standard Material: Polyethylene*

161 Series

Rectangular Caps for Bar Steel are manufactured with a rounded or flat base, and serve as an excellent means for capping the ends of bar steel.

RECTANGULAR CAPS FOR BAR STEEL



PART NUMBER	LEG LENGTH	LEG GAUGE	MATERIAL	COLOR
159PB-0750-0000	0.750"	0.125"	POLYETHYLENE	BLACK
159PB-1000-0000	1.000"	0.125"	POLYETHYLENE	BLACK
159PB-1125-0000	1.250"	0.125"	POLYETHYLENE	BLACK
159PB-1128-0000	1.500"	0.125"	POLYETHYLENE	BLACK

SPECIFICATIONS

- *Standard Color: Black*
- *Standard Material: Polyethylene*

159 Series

Angle Iron Caps are the low cost answer to the problem of protecting floors from the sharp edges of angle iron furniture. Angle Iron Caps are also used as caps on metal bed frames and shelves and will not rust while also eliminating the cost of welding steel closures.

ANGLE IRON CAPS



CAPS

FERRULES & TIPS

ROUND FERRULE

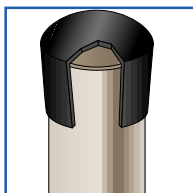

PART NUMBER	TUBE O.D. SIZE	BOX QTY	MATERIAL	COLOR
FRD-0375	3/8"	20,000	LOW DENSITY POLYETHYLENE	BLACK
FRD-0437	7/16"	10,000	LOW DENSITY POLYETHYLENE	BLACK
FRD-0500	1/2"	5,000	LOW DENSITY POLYETHYLENE	BLACK
FRD-0625	5/8"	5,000	LOW DENSITY POLYETHYLENE	BLACK
FRD-0750	3/4"	4,000	LOW DENSITY POLYETHYLENE	BLACK
FRD-0875	7/8"	2,500	LOW DENSITY POLYETHYLENE	BLACK
FRD-1000	1"	2,000	LOW DENSITY POLYETHYLENE	BLACK
FRD-1125	1-1/8"	1,000	LOW DENSITY POLYETHYLENE	BLACK
FRD-1250	1-1/4"	1,000	LOW DENSITY POLYETHYLENE	BLACK
FRD-1500	1-1/2"	500	LOW DENSITY POLYETHYLENE	BLACK
FRD-1750	1-3/4"	500	LOW DENSITY POLYETHYLENE	BLACK
FRD-2000	2"	300	LOW DENSITY POLYETHYLENE	BLACK
FRD-2500	2-1/2"	200	LOW DENSITY POLYETHYLENE	BLACK
FRD-3000	3"	150	LOW DENSITY POLYETHYLENE	BLACK

SPECIFICATIONS

- Standard Color: Black
- Standard Material: Low Density Polyethylene

FRD Series

Provides a neat finish to products manufactured from tubular steel.

SQUARE FERRULE



PART NUMBER	TUBE O.D. SIZE	BOX QTY	MATERIAL	COLOR
FSQ-0625	5/8"	4,000	LOW DENSITY POLYETHYLENE	BLACK
FSQ-0875	7/8"	2,000	LOW DENSITY POLYETHYLENE	BLACK
FSQ-1000	1"	1,000	LOW DENSITY POLYETHYLENE	BLACK
FSQ-2000	2"	250	LOW DENSITY POLYETHYLENE	BLACK

SPECIFICATIONS

- Standard Color: Black
- Standard Material: Low Density Polyethylene

FSQ Series

Provides a neat finish to products manufactured from square tubular steel.

TAPERED FERRULE

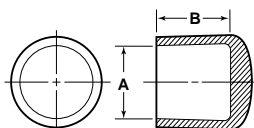

PART NUMBER	DIMENSIONS		BOX QTY	MATERIAL	COLOR
	A	B			
FTP-0187	3/16"	15/32"	10,000	PVC	BLACK
FTP-0250	1/4"	15/32"	10,000	PVC	BLACK
FTP-0312	5/16"	9/16"	10,000	PVC	BLACK
FTP-0312-LP	5/16"	29/32"	10,000	PVC	BLACK
FTP-037	3/8"	5/8"	5,000	PVC	BLACK
FTP-0500-LP	1/2"	29/32"	4,000	PVC	BLACK

SPECIFICATIONS

- Standard Color: Black
- Standard Material: PVC
- Optional Material: LDPE indicated by "LP" Part No. suffix.

FTP Series

Tapered Ferrules are often used as a safety cap on protruding steel rods or bars.





PART NUMBER	HOLE DIAMETER	MAXIMUM THICKNESS	HEAD DIAMETER B	THICKNESS C
PLH-001	0.187	0.062	0.250	0.234
PLH-002	0.250	0.062	0.312	0.312
PLH-003	0.312	0.062	0.375	0.312
PLH-004	0.375	0.125	0.468	0.406
PLH-005	0.437	0.125	0.531	0.406
PLH-006	0.500	0.125	0.578	0.406
PLH-007	0.562	0.125	0.656	0.406
PLH-008	0.625	0.125	0.718	0.406
PLH-009	0.687	0.125	0.781	0.406
PLH-010	0.750	0.125	0.922	0.406
PLH-011	0.812	0.125	0.890	0.406
PLH-012	0.875	0.125	1.016	0.406
PLH-013	1.000	0.125	1.203	0.406
PLH-014	1.093/1.125	0.125	1.218	0.406
PLH-015	1.187	0.125	1.312	0.406
PLH-016	1.250	0.125	1.375	0.406
PLH-017	1.375	0.125	1.500	0.406
PLH-018	1.500	0.125	1.672	0.406
PLH-019	1.750	0.125	1.925	0.406
PLH-020	2.000	0.250	2.140	0.406

SPECIFICATIONS

- Standard Color: Black
- Standard Material: Nylon

PLH Series

Multiple locks to positively snap in panel thicknesses ranging from 1/64" to 1/8". Close excess chassis holes, wiring outlets, and production access holes. Molded of heat stabilized nylon (UL94V2), and may be more suitable for critical or elevated temperature applications.



PART NUMBER	HOLE DIAMETER	MAXIMUM THICKNESS	HEAD DIAMETER B	THICKNESS C
PLV-001	0.750	0.125	0.906	0.406
PLV-002	0.875	0.125	1.016	0.453
PLV-003	1.000	0.125	1.203	0.453

SPECIFICATIONS

- Standard Color: Black
- Standard Material: Nylon

PLV Series

Multiple locks to positively snap in panel thicknesses ranging from 1/64" to 1/8". Close excess chassis holes, wiring outlets, and production access holes. Molded of heat stabilized nylon (UL94V2), and may be more suitable for critical or elevated temperature applications. Locking Vent Plugs are available in the 3/4", 7/8" and 1" diameters.

LOCKING HOLE PLUGS

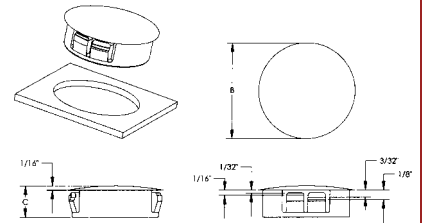

LOCKING VENT PLUGS

